

# Historic Solutions





# Table of Contents

---

<b>OVERVIEW</b>	<b>04 Marvin Ultimate™ Historic Solutions Introduction</b>
	06 Unmatched Expertise
	08 Double Hung G2 Casing
	10 Simulated Check Rails + Lift Locks
	12 Exterior Casings + Subsills
	14 Radius Shapes
	16 Custom Shapes

---

<b>CUSTOMIZATION</b>	<b>18 Introduction</b>
	20 Customization + Finish Options
	22 Custom Windows + Doors

---

<b>CASE STUDIES</b>	<b>24 Introduction</b>
	26 The Church
	28 Queen Anne
	30 Cincinnati Music Hall
	32 Lehigh University
	34 The Mill
	36 Christ Episcopal Church

---

DIRECT GLAZE ROUND TOP,  
SPECIALTY SHAPE WINDOWS  
Bronze

# Uniquely Qualified to Handle Your Piece of History

For generations, Marvin has built a reputation for doing the tough window and door projects. We've been solving historic rehabilitation challenges for residential and commercial spaces longer than anyone else, and we know the ins and outs—collaborating early on with architects, facilities managers and general contractors, reviewing products and options, navigating the National Parks Service guidelines, discussing window specifications with local historic commissions, and attending field testing.

We offer the best project-based solutions and work with all stakeholders and partners to achieve exceptional historical accuracy and performance.

## A Campaign to Save a Courthouse

See how original courthouse windows were replicated in a new addition with visually matched, but more cost-effective, Marvin Ultimate™ Double Hung Picture windows. Read more on the Marvin Inspiration blog.



[marvin.com/courthouse](https://marvin.com/courthouse)

DOUBLE HUNG PICTURE  
G2 WINDOWS  
Sierra White



# Unmatched Expertise

With products across thousands of residential spaces, university campuses, government buildings, places of worship, and Main Street storefronts, Marvin is a proven leader in crafting customized historic windows and doors for any space. When repair isn't an option, Marvin teams work with project owners, architects, and design teams to find the solution that meets historical guidelines while providing state-of-the-art performance, energy efficiency, operation, and durability.

CUSTOM WINDOW DESIGN  
Marvin Signature Services



# Historic Casing Options

With the Marvin Ultimate™ Single or Double Hung G2 historic casing option, projects benefit from improved mass and proportionality of the sash, frame, and casing, along with reduced shadow lines for a truly historically accurate result.

When compared with a traditional historic wood double hung, casing and blind stop profiles are accurately dimensioned. This attention to detail allows the sash and glass to remain in the same plane, maintaining the relationship between the edge of glass and the masonry opening.

Several casing options are available, as well as custom casing profiling capabilities to match existing exterior details.

*fig. 1* SINGLE HUNG G2 WINDOW  
Stone White

*fig. 2* DOUBLE HUNG G2  
HISTORIC CASING OPTION

*fig. 3* TRADITIONAL HISTORIC  
WOOD DOUBLE HUNG

*fig. 4* TRADITIONAL (RED) VS. MARVIN  
HISTORIC CASING OPTION (BLACK)

*fig. 5* EXTERIOR SASH LUG, OGEE PROFILE  
Gunmetal

*fig. 6* RIDGELAND PROFILE CASING  
Gunmetal

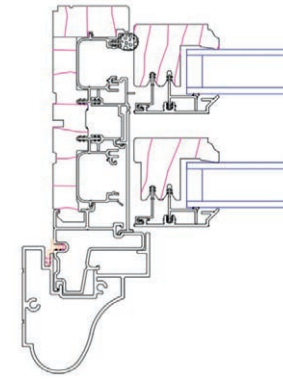

*fig. 2*

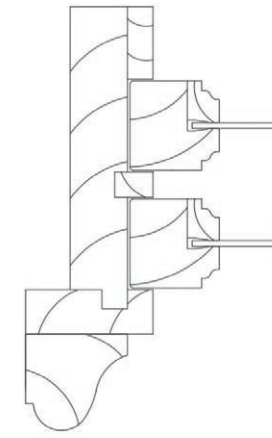

*fig. 3*

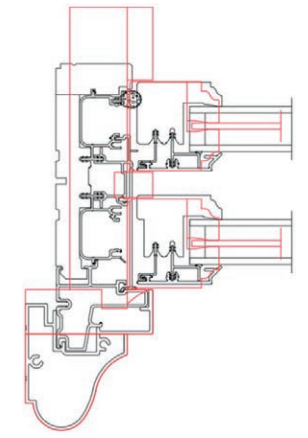

*fig. 4*



*fig. 1*



*fig. 5*



*fig. 6*

## Simulated Check Rails

Merging historic tradition with modern performance typically requires creative thinking and customized solutions. When replacing existing windows that are “beyond repair,” Marvin will work with you to develop solutions—such as a simulated checkrail shown in the drawing below—that recreate historic profiles and details.

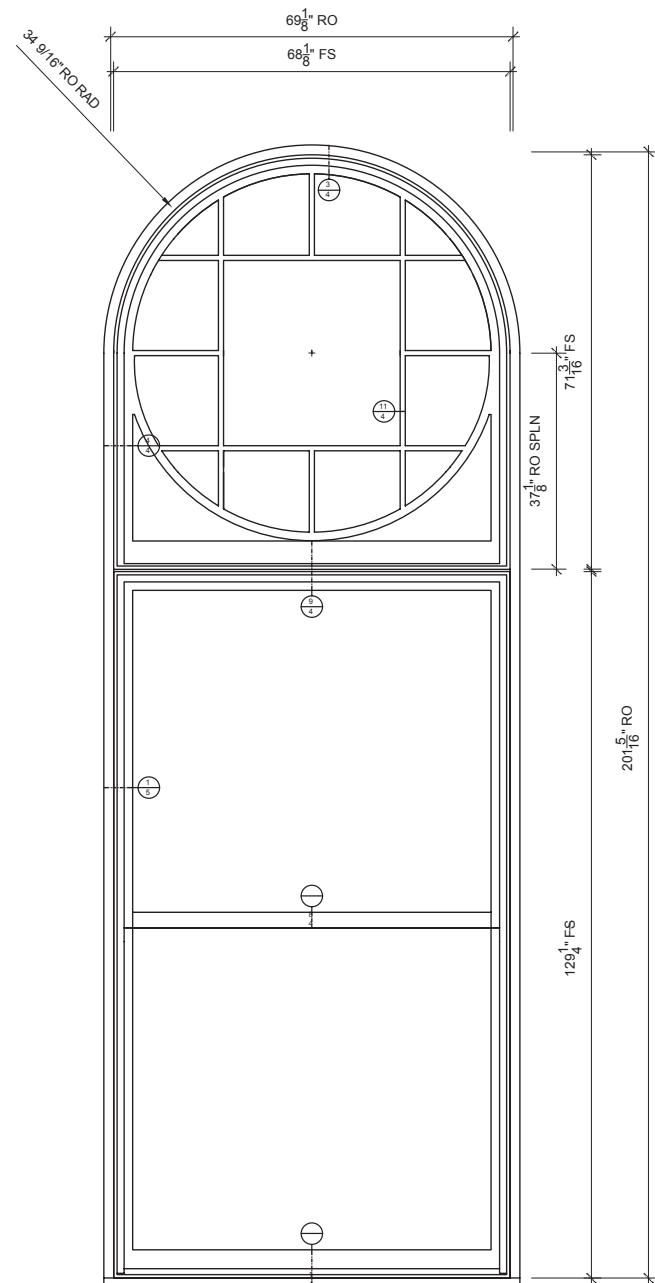

fig. 1

fig. 1 SIMULATED CHECKRAIL  
TECHNICAL DRAWING  
Stone White

fig. 2 SINGLE HUNG G2 WINDOW  
WITH LIFT LOCK  
Hazelnut Stain

## Lift Locks

The Marvin Lift Lock is the next innovation in function, design, and aesthetics for the Marvin Ultimate™ Single Hung G2 window. Moving the location of the lock from the check rail to the lower part of the sash solves an age-old problem of lock accessibility. Now, the Lift Lock closes and acts as a handle for raising and lowering the bottom sash. To lock, simply close the bottom sash.

The operation of the window works seamlessly even with limited hand dexterity or range of motion. With the Lift Lock, key features of the Marvin Ultimate Single Hung G2 are maintained, including expansive sizes up to 5" wide by 10" high, and a DP40 performance rating, making it a perfect solution for residential and commercial projects.



TRADITIONAL LIFT LOCK



CONTEMPORARY LIFT LOCK



fig. 2

# Exterior Casings + Subsills

Adding Marvin clad or wood casings and subsills provides great architectural details to any project. We offer hundreds of clad and wood casing options that can be customized to match existing profiles.

Our clad casings are made of ultra-durable extruded aluminum, which features an extremely durable factory applied finish that resists chalking, fading, pitting, corrosion, and marring, and is backed by a 20-year warranty against chalk and fade. Meets AAMA 2605 requirements.

fig. 1 DOUBLE HUNG G2 WINDOWS  
Coconut Cream



fig. 1



BRICK MOULD CASING  
A246 SUBSILL



FLAT CASING  
A246 SUBSILL



COLUMBUS CASING  
A1450 SUBSILL



THORTON CASING  
A1450 SUBSILL



RIDGELAND CASING  
A1453 SUBSILL



STRATTON CASING  
A1453 SUBSILL



GRAYSON CASING  
A1451 SUBSILL

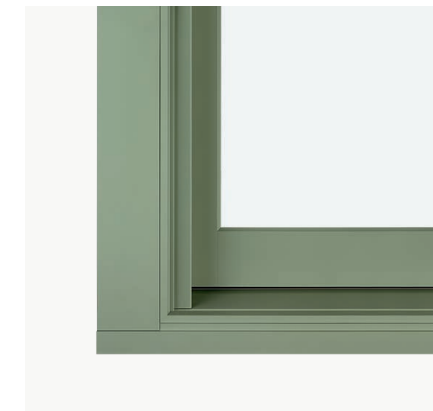

POTTER CASING  
A217 SUBSILL (BOTTOM)



POTTER CASING  
A217 SUBSILL (TOP)

# Radius Shapes

Some projects call for window units or assemblies designed with graceful radius curves on the exterior and rectangular, operating hung windows on the interior. Marvin has a range of radius variations available for design flexibility.

The range of Marvin radius window and door options ensures architects can accurately replicate the details and designs that are key to a building's historic fabric and aesthetic.



fig. 1

fig. 1 **DOUBLE HUNG G2 WINDOW, INSWING FRENCH ARCHTOP DOOR**  
Painted White

fig. 2 **DIRECT GLAZE ROUND TOP WINDOW**  
Painted White



**Eyebrow and Half Eyebrow Radius Operating Double Hung**  
A classic look with a gentle eyebrow radius. Beautiful as a stand-alone window or as part of an assembly.



**Half Eyebrow Single Hung**  
This striking window style adds elegant curves to a two-wide window assembly (not shown). Available on Single Hung only.



**Half Circle Radius Operating Double Hung**  
A dramatic window with a true half circle arch. The look gives a beautifully smooth transition from jamb to header. Both sashes are operable.



**Eyebrow Transom and Picture**  
This stationary window is available as a transom or picture window. These windows are designed to complement the Ultimate Double Hung G2 window with correlating sizes and matching springline.



**Half Circle Transom**  
This simulated half circle transom window can be sized to stand alone or easily fit above a double hung window.



fig. 2

# Custom Shapes

Marvin is able to replicate one-of-a-kind windows that make historic buildings unique across all types of geometric shapes. When bringing an old building back to life, these types of windows help define the true character of the building.

*fig. 1* **DIRECT GLAZE ROUND TOP WINDOWS**  
Painted White

*fig. 2* **CUSTOM WINDOW DESIGN**  
Marvin Signature Services



*fig. 1*



*fig. 2*

**MARVIN**  
**ULTIMATE™**  
**COLLECTION**

# Designed for Unique Visions

Marvin Ultimate windows and doors help unlock a stunning range of singular visions – from contemporary to historic. The result of relentless refinement, the Ultimate collection pushes the limits of what’s possible.

---

**HANDCRAFTED BEAUTY**

---

**SUPERIOR PERFORMANCE**

---

**DESIGN FLEXIBILITY**

---

SINGLE HUNG G2 WINDOWS  
WITH HISTORIC CASING OPTION  
Stone White



# Ultimate Customization

Our low maintenance clad-wood products feature an extruded aluminum exterior finished in commercial-grade high performance PVDF fluoropolymer paint. Because our finish meets the toughest American Architectural Manufacturers Association (AAMA) 2605 standard, you can expect even our richest and boldest hues to resist fading and chalking. Color options span from muted, earthy tones to bold, rich colors and include three pearlescent finishes. Custom color matching is also available to meet any design vision.

AAMA awards certifications to materials that pass numerous, rigorous tests that simulate the harsh conditions that a finish will encounter throughout the life of the window or door. Achieving AAMA verification provides independent verification that Marvin finishes are best-in-class.



# Finish Options

## Wood Interiors

Before assembling windows and doors, each individual piece of wood is sanded, conditioned, stained, and oven-cured. Finished pieces are clear-coated and then sanded and coated again, providing an ideal finish.

### WOOD SPECIES

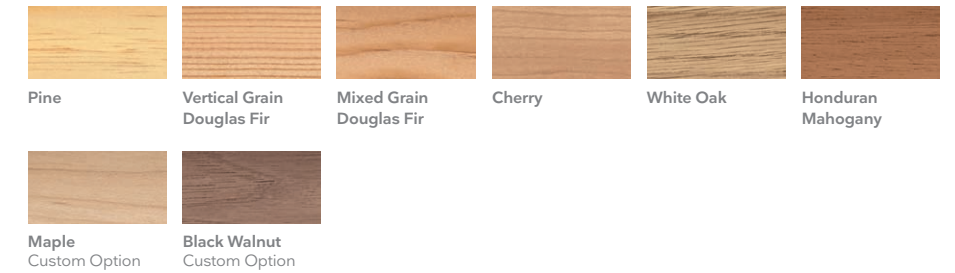

## Wood Exteriors

Wood is a premium material for windows and doors, offering classic aesthetic appeal, customization, and design versatility. Choose from four exterior options, ready to be finished to match your project's exacting requirements.

### WOOD SPECIES

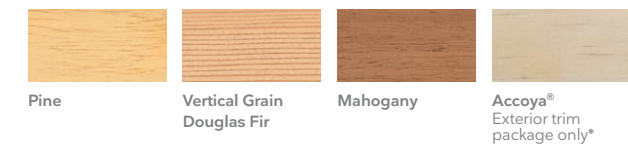

\* Accoya trim is a high-performance modified wood made from Radiata Pine that undergoes acetylation to minimize water absorption, resulting in exceptional stability and durability for exterior applications

## Extruded Aluminum Colors

Extruded aluminum is an extremely tough cladding that protects wood windows, mimics the profiles of wood, and provides superior durability.

Select from a variety of colors, or work with us to create a custom color.

### EXTRUDED ALUMINUM FINISHES



## Custom Windows and Doors Built With a Critical Eye for Historic Detail

When it comes to historic projects, the small details can make a big difference. Marvin is known throughout the industry for providing the intricate, historically accurate profiles and features that match the architectural period and gain approvals from historic boards.

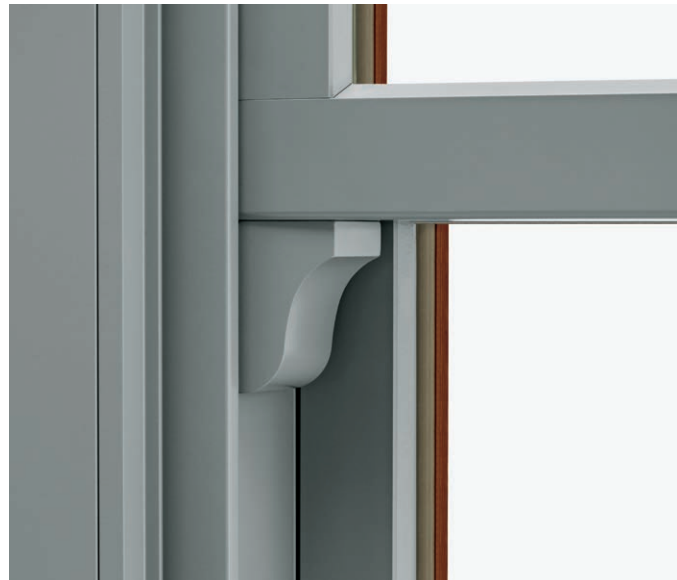

### Interior and Exterior Sash Lug

Replication sometimes requires exterior or interior lugs. Factory applied, or field application kits are available.



### Ultimate Wood Double Hung Chain and Pulley

Contributes to the authentic appearance of replacement windows. Available in a variety of styles and finishes.

### Commercial Doors

The Marvin Ultimate™ Commercial door combines sophisticated design with rugged durability to stand up to years of commercial use. Available in a wide variety of design and customization options, Ultimate Commercial doors are manufactured with different construction and assembly processes than Marvin's residential doors.

Commercial doors are available in wood or clad-wood styles to match historic design needs, with an optional commercial hardware package, including closer, mortise lock, rim device, kick plate, and removable mullions.



### Divided Lites and Authentic Divided Lites

Patterns can feature an array of muntin widths, unique muntin profiles, rectangular or radius cuts, and more. Custom divided lites available.



### Glass and Glazing

An array of decorative and specialty glass options are available to recreate the look of antique panes, including Restoration glass or Circa glass, along with glazing options to meet requirements for sound abatement. Multiple glass options meet standards in energy efficiency for various regions, climates, and California fire zone specifications.

# Case Studies

DOUBLE HUNG G2 WINDOWS,  
INSWING FRENCH ARCHTOP DOOR  
Ebony



## A New Chapter for the Hadley House

An impressive interior renovation—including massive 7' Marvin Ultimate™ Double Hung G2 windows—helped transform a 19th-century home in Wenham, Massachusetts. Learn more on the Marvin Inspiration blog.



[marvin.com/hadley-house](https://marvin.com/hadley-house)

# The Church

An adaptive reuse project, “The Church” is a 12,000-square-foot former Methodist Church, built in 1835. Having weathered nearly two centuries with its strong bones of vaulted ceilings and heavy beams, Architect Lee Skolnick of Skolnick Architecture + Design worked with artists and community activists Eric Fischl and April Gornik to transform the church into a center for the arts. The building features Marvin Ultimate™ Direct Glaze, Casement and Awning windows, and Inswing French doors. The exterior windows are clad in aluminum, a design choice that had to be brought before an architectural review board for approval to ensure the church upheld its historic integrity.

**PROJECT TYPE**

Adaptive Re-use

**LOCATION**

Sag Harbor, New York

**ARCHITECT**

Skolnick Architecture + Design

**FEATURED PRODUCTS**

Ultimate Direct Glaze,  
Casement, Awning Windows,  
Inswing French Doors

Photos by © Scott Frances/OTTO

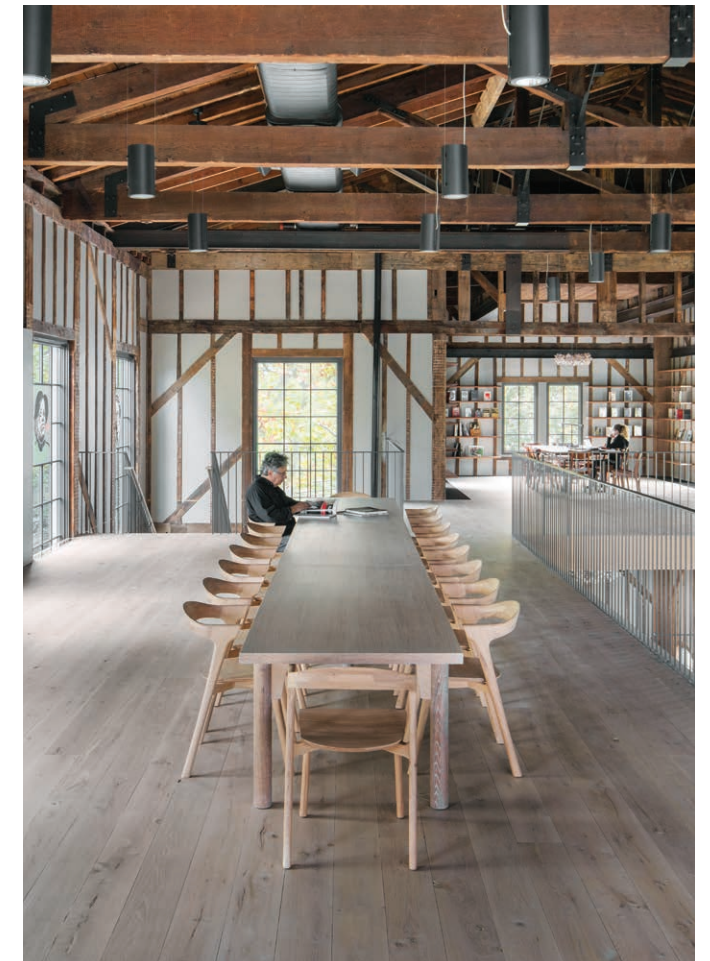

# Queen Anne

When a young couple purchased this 1910s-era colonial revival in the Queen Anne neighborhood of Seattle, they loved the home's classic, quintessentially American architecture but wanted to update and modernize it without compromising its original character, charm, and period detail. Making the home more energy efficient was an important goal for the owners; the decision was made to replace all of the original windows and add more glazing. The new Marvin Ultimate™ windows kept with the scale and style of the original house, and Marvin was able to replicate the lite proportions of the original windows. The Ovolo detailing on the new Marvin windows and doors was almost identical to the sticking that was on the original windows.

**PROJECT TYPE**  
Residential Remodel

**LOCATION**  
Seattle, Washington

**ARCHITECT**  
Adams Architecture

**FEATURED PRODUCTS**  
Ultimate Double Hung G2,  
Casement Windows,  
Swinging French Doors



# Cincinnati Music Hall

Originally built in 1878, the Cincinnati Music Hall reopened in October 2017 after a \$143 million renovation that revived its former architectural glory and enhanced the audience experience. With its gabled roof, decorative brick work, and signature window tracery, the building is a prime example of High Victorian Gothic Revival style.

It is one of only approximately 2,500 designated national historic landmarks, the highest level of historic significance that a building can achieve in the United States. Featuring over 100 Marvin Ultimate™ Wood Double Hung G2 windows, the Marvin team worked closely with builders, historic preservationists, architects, and other specialists to help navigate the complex guidelines a historic project like this one requires.

**PROJECT TYPE**

National Historic  
Landmark Renovation

**LOCATION**

Cincinnati, Ohio

**ARCHITECT**

Alan Weiskopf, PWWG  
Architects

**FEATURED PRODUCTS**

Ultimate Wood Double Hung  
G2, Specialty Shapes Windows



# Lehigh University

How do you set a path for the future without losing the history that made something special? That was the task in front of the project team for the renovation of Lehigh University's Packer Hall in Bethlehem, Pennsylvania. Like with the building itself, the goal of the window and door program was to nod to the history while improving the look and performance. The new Marvin Ultimate™ Direct Glaze Round Top windows completely opened up previously darkened spaces.

“Before the renovation, we had storm windows, muntins on top of screens,” Jim LaRose, Lehigh Facilities lead project manager, said. “There were multiple layers the light had to struggle through.”

On the performance end, the new units have a U-value between .27 and .29, greatly improving on the energy efficiency of the previous operable, single panes.

Nick Christy, Lehigh Associate Director for Student Involvement and Student Center Operations, summed it up: “With the new windows, with the new lighting, you feel energized by just walking in the building.”

**PROJECT TYPE**

Commercial

**LOCATION**

Bethlehem, Pennsylvania

**ARCHITECT**

Shepley Bulfinch

**FEATURED PRODUCTS**

Ultimate Direct Glaze Rectangle,  
Direct Glaze Round Top,  
Specialty Shape Windows,  
Commercial Door



# The Mill

This 147-unit apartment project is an adaptive re-use of seven historic brick structures built between 1848 and 1957, as well as several ancillary steel structures. The space is aimed at supporting and expanding the economic growth of Prattville's revitalizing downtown. Complex amenities include a clubhouse, fitness center, business center and community room, event space, pavilions, courtyards, and green space.

The design was crafted in close collaboration with historic consultants and the National Parks Service. Chambless King Architects turned to Marvin Ultimate™ products to help preserve the historic integrity of the site.

PROJECT TYPE  
Adaptive Re-Use

LOCATION  
Prattville, AL

ARCHITECT  
Chambless King

FEATURED PRODUCTS  
Ultimate Double Hung G2,  
Casement Picture Windows,  
Outswing French, Inswing  
French Doors



# Christ Episcopal Church

Christ Episcopal Church, located in the Callowhill Historic District of Reading, Pennsylvania, boasts an original building that dates to 1826. But it was the parish hall, built in 1952, that was in desperate need of modernization. Facing challenges with outdated windows, including compromised energy efficiency and security, the church embarked on a renovation journey.

With the guidance of esteemed architectural firm Muhlenberg Greene and an area Marvin architectural project manager, Christ Episcopal selected Marvin Ultimate™ Venting Picture windows. The design and function of the window met all the project requirements of improved daylight to the interior space, energy efficiency and safety with an added benefit: air flow through the patented, hidden screen system.

**PROJECT TYPE**  
National Historic  
Landmark Renovation

**LOCATION**  
Reading, PA

**ARCHITECT**  
Muhlenberg Greene

**FEATURED PRODUCTS**  
Ultimate Casement Venting  
Picture, Awning Windows





MARVIN ULTIMATE™ DOUBLE HUNG PICTURE G2 WINDOWS  
Sierra White



Since 1912, Marvin has been a family-owned and -led company, with a legacy of innovation and commitment to the highest quality. We understand the unique opportunity windows and doors have to improve our spaces and how we feel in them. That's why we never stop pushing what's possible and inventing new solutions to channel fresh air, enhance light quality, and connect with the world around us.

**MARVIN.COM**

© 2026 Marvin Lumber and Cedar Co., LLC. All rights reserved.  
® Registered trademark of Marvin Lumber and Cedar Co., LLC.

Accoya®, Tricoya® and the Trimarque Device are registered trademarks of Titan Wood Limited and may not be used or reproduced without written permission.

Part 19983283. May 2026.

Cover Image: Marvin Ultimate™ Direct Glaze Round Top Window

Colors shown in printed materials are simulations and may not precisely duplicate product or finish colors. Contact your local Marvin dealer to view actual product and finish color samples.